

robot coupe®

NEW
Register
your product
on line



J 80 • J 80 Buffet • J 100

www.robot-coupe.com

@ Register your product on line

robot coupe

The company | Contact us | Restricted Area | Select your country...

CATALOGUE ▾ SELECTION GUIDE LEAFLETS VIDEOS OUR **SUPPORT** Search

SUPPORT

Register your product online

Thank you for registering online your Robot-Coupe product
This should only take a few minutes
To register your product you will need:

- Product serial number
- Purchase date

Register my product now

Access the Robot-Coupe after-sales service

robot coupe
Authentication

Bienvenue sur le site SAV de Robot-Coupe

Choisissez votre langue : English | US | Italian | Spanish | Deutsch | Russia

Identifiant *
Mot de passe *

Mot de passe perdu
Email *

Pour nous contacter
→ utilisez notre formulaire de contact

Access the Robot-Coupe after-sales service

robot coupe®

EU Declaration of Conformity

Robot-Coupe® SNC declares that all the machines subject of these original instructions, as well as their accessories and their packaging, comply with:

- the essential requirements of the following European directives and with the corresponding national regulations :
 - Directive "Machinery" **2006/42/EC**,
 - Directive "Low Voltage" **2014/35/EU**,
 - Directive "Electromagnetic Compatibility" **2014/30/EU**,
 - Directive "Reduction of Hazardous Substances in Electrical Equipment" (RoHS) **2011/65/EU**,
 - Directive "Waste Electrical and Electronic Equipment" (WEEE) **2012/19/EU**,
- Regulation (EC) No **1907/2006** (latest consolidated version) "concerning the Registration, Evaluation, Authorisation and Restriction of Chemicals (REACH)" and as such, no product, accessory and their packaging sold by Robot-Coupe® SNC, contains any substance on the European Chemical Agency (ECHA) candidate list and considered of very high concern.
- Regulation (EC) No **1935/2004** "Materials and articles intended to come into contact with food" modified by regulation (EC) No 596/2009.
- Regulation (EC) No **2023/2006** "Good manufacturing practice for materials and articles intended to come into contact with food".
- Regulation (EU) No **10/2011** "Plastic materials and articles intended to come into contact with food", as well as all relevant (EU) regulations which modify, correct and/or rectify it, as at the date of this declaration, the regulations (EU) No 1282/2011, 1183/2012, 202/2014, 865/2014, 2015/174, 2016/1416, 2017/752, 2018/79, 2018/213, 2018/831 and 2019/37.

- the provisions of the following harmonized European standards and the standards specifying the safety and hygiene requirements:

- **EN ISO 12100:2010** Safety of machinery – General principles for design,
- **EN 60204-1:2006** Safety of machinery – Electrical equipment of machines,
- **EN 60529** Degrees of protection provided by enclosures (IP Code):
 - IP 55 for the electric controls,
 - IP 34 for the other parts of the machine,

- and according to the category of the apparatus, with the provisions of the following harmonized European standards specifying the safety and hygiene requirements:

- **EN 454** Planetary Mixers,
- **EN 1678** Vegetable Cutting Machines (and Juice Extractors),
- **EN 12852** Food Processors and Blenders,
- **EN 12853** Hand-Held Blenders and Whisks (Power Mixers),
- **EN 13208** Vegetable Peelers,
- **EN 13621** Salad Dryers,
- **EN 14655** Baguette Slicers.

"R019"

Montceau-en-Bourgogne, on March 1st, 2019

Jean-Marie LOZANO
Director of Industrial Operations



SUMMARY

■ WARRANTY

■ IMPORTANT WARNING

■ YOU HAVE JUST ACQUIRED A
J 80 - J 80 Buffet - J 100 JUICER

■ SWITCHING ON THE MACHINE

■ ASSEMBLY J 80

■ ASSEMBLY J 80 Buffet

■ ASSEMBLY J 100

■ RECOMMENDATIONS FOR USE

■ CLEANING

■ TECHNICAL SPECIFICATIONS

■ SAFETY

■ TROUBLESHOOTING

■ STANDARDS

■ TECHNICAL DATA

- Parts diagram
- 39910 basket assembly sheet

ROBOT-COUPÉ S.N.C., LIMITED WARRANTY

Your new ROBOT-COUPÉ appliance is warranted to the original buyer for a period of one year from the date of sale if you bought it from ROBOT-COUPÉ S.N.C.

If you bought your ROBOT-COUPÉ product from a distributor your product is covered by your distributor's warranty (Please check with your distributor terms and conditions of the warranty).

The ROBOT-COUPÉ S.N.C. limited warranty is against defects in material and/or workmanship.

THE FOLLOWING ARE NOT COVERED BY THE ROBOT-COUPÉ S.N.C. WARRANTY:

1 - Damage caused by abuse, misuse, dropping, or other similar damage caused by or resulting from failure to follow assembly, operating, cleaning, user maintenance or storage instructions.

2 - Labour to sharpen and/ or replacements for blades which have become blunt, chipped or worn after a normal or excessive period of use.

3 - Materials or labour to replace or repair scratched, stained, chipped, pitted, dented or discoloured surfaces, blades, knives, attachments or accessories.

4 - Any alteration, addition or repair that has not been carried out by the company or an approved service agency.

5 - Transportation of the appliance to or from an approved service agency.

6 - Labour charges to install or test new attachments or accessories (i.e., bowls, discs, blades, attachments) which have been arbitrarily replaced.

7 - The cost of changing direction-of-rotation of three-phase electric motors (Installer is responsible).

8 - SHIPPING DAMAGES. Visible and latent defects are the responsibility of the freight carrier. The consignee must inform the carrier and consignor immediately, or upon discovery in the case of latent defects.

KEEP ALL ORIGINAL CONTAINERS AND PACKING MATERIALS FOR CARRIER INSPECTION.

Neither ROBOT-COUPÉ S.N.C. nor its affiliated companies or any of its distributors, directors, agents, employees, or insurers will be liable for indirect damage, losses, or expenses linked to the appliance or the inability to use it.

The ROBOT-COUPÉ S.N.C. warranty is given expressly and in lieu of all other warranties, expressed or implied, for merchantability and for fitness toward a particular purpose and constitutes the only warranty made by ROBOT-COUPÉ S.N.C. France.

IMPORTANT WARNING



WARNING: In order to limit accidents such as electric shocks or personal injury, and in order to limit material damage due to misuse of the appliance, please read these instructions carefully and follow them strictly. Reading the operating instructions will help you get to know your appliance and enable you to use the equipment correctly. Please read these instructions in their entirety and make sure that anyone else who may use the appliance also reads them beforehand. Our equipment is designed for professional use and must not be used by children under any circumstances.

UNPACKING

- Carefully remove the appliance from its packaging, together with all the boxes or packets containing the accessories or specific items of equipment.
- **WARNING:** the blades and discs are extremely sharp.

INSTALLATION

- We recommend that you install your appliance on a clean and completely stable countertop at a comfortable working height.

CONNECTION

- Always check that your power supply corresponds to that indicated on the serial number plate and that it is properly sized.

ASSEMBLY PROCEDURES

- Make sure you follow the assembly instructions in the right order (see following pages) and check that all the accessories are correctly positioned.

USE

- **Never remove the lid until the motor and basket have come to a complete standstill.**

- **Never insert anything other than fruit or vegetables into the feed tube.**
- **The lid of your appliance features a unique Auto Feed system. Simply feed the fruit or vegetables into the tube and let the machine do the rest.**
- **If a blockage occurs inside the feed tube, NEVER use any object other than the pusher to clear it.**
- **Never insert your hand into the ejection chute. If the ejection chute gets clogged, stop the juicer and wash the lid under running water.**
- **Never leave the machine running unattended.**

CLEANING

- **Always unplug your machine before cleaning.**
- **Always clean the machine and attachments at the end of each use.**
- **Never clean the machine with a pressure washer or foam lance.**
- **Never place the motor unit in water.**
- **Be sure to use the appropriate detergent for each part (stainless steel or plastic).**

- **For plastic parts, do not use detergents that are too alkaline (i.e., containing too much caustic soda or ammonia...).**
- **The bowl, lid and pulp container are all dishwasher-safe. However, to prolong their lifespan, we advise hand-washing them with a domestic washing-up liquid.**
- **Robot Coupe can in no way be held responsible for the user's failure to follow the basic rules of cleaning and maintenance.**

MAINTENANCE

- **Always unplug the appliance before servicing.**
- **The watertightness of the motor shaft needs to be monitored on a regular basis. At the same time, check that the safety system is working properly.**
- **WARNING: never switch your appliance on if the power cord or plug has been damaged.**
- **If the appliance is not working properly or has been damaged in any way, unplug it and have it overhauled.**
- **Do not hesitate to call your ROBOT-COUPÉ approved after-sales service if you notice a fault.**

YOU HAVE JUST ACQUIRED A J80 - J80 Buffet - J100 JUICER

Stable and sturdy, the J80-J80 Buffet-J100 can produce any number of 100% natural juices on demand and in next to no time!

The J80-J80 Buffet-J100 juicer is ideal for making fresh juices from vegetables and locally-grown or tropical fruit, as well as sophisticated cocktails, all totally pure and natural.

It therefore has applications in bars, restaurants, canteens, institutions and day nurseries, as well as in healthcare settings and in the production of dietetic foods, where fresh fruit and vegetable juices play a key role.

Fruit and vegetables, especially when they are raw, represent a valuable source of the vitamins, minerals and fibers our bodies need to stay healthy. Vegetable juices contain mainly mineral salts, while fruit juices are packed full of vitamins to boost our energy.

MINERAL SALTS

Not all foods contain the same mineral salts.

Some minerals, such as potassium, magnesium, sulphur and sodium chloride (salt) are so widespread that a varied diet will always ensure a sufficient intake. For some minerals, however, it is useful to know which are the best sources.

Calcium : fruit and green vegetables.

Phosphorus : pulses.

Potassium : fresh vegetables.

Iron : spinach, parsley.

Iode : all plants.

TABLE OF VITAMINS IN FRUIT

Vitamins	B1	C	A	D
Apricot	•	•	•	•
Pineapple	•	•	•	•
Blackcurrant	•	•		•
Cherry	•	•	•	•
Lemon	•	•	•	•
Strawberry	•	•		•
Raspberry	•	•		•
Redcurrant	•	•		•
Kiwi fruit	•	•	•	•
Melon	•	•		•
Blackberry	•	•	•	•
Orange	•	•	•	•
Grapefruit	•	•	•	•
Peach	•	•		•
Pear	•	•		•
Apple	•	•		•
Plum	•	•		•
Grape	•	•		•

TABLE OF VITAMINS IN VEGETABLES

Vitamines	B1/B6	A	E	K
Asparagus	•		•	
Carrot	•	•	•	
Celery		•	•	•
Celeriac	•			
Cabbage	•	•	•	•
Cucumber	•	•	•	
Courgette	•	•	•	
Watercress	•	•	•	
Chicory	•			
Spinach	•	•	•	•
Fennel	•		•	
Lettuce	•		•	•
Turnip	•			
Onion	•			
Parsley	•	•	•	
Pepper	•	•	•	
Tomato	•	•		

Your appliance's straightforward design means that the parts which most frequently need to be handled for cleaning or aftercare can be removed in no time at all.

To make life even easier for you, these instructions guide you through each of the assembly operations, broken down into simple steps.

These instructions contain important information to help users make the most of their juicer.

We therefore strongly advise you to read through them carefully before you start to use your appliance.

SWITCHING ON THE MACHINE

Before connecting your appliance to the mains, check that the voltage of your power supply matches that indicated on your appliance's identification plate.

The J80-J80 Buffet-J100 juicer is equipped with a power cord and a standard single-phase wall plug.

Check the machine carefully on arrival to ensure that it has not been damaged during transport or unpacking.

Pay particular attention to the power cord and plug.



WARNING

THIS APPLIANCE MUST BE PLUGGED INTO AN EARTHED SOCKET (RISK OF ELECTROCUTION).

ASSEMBLY J80

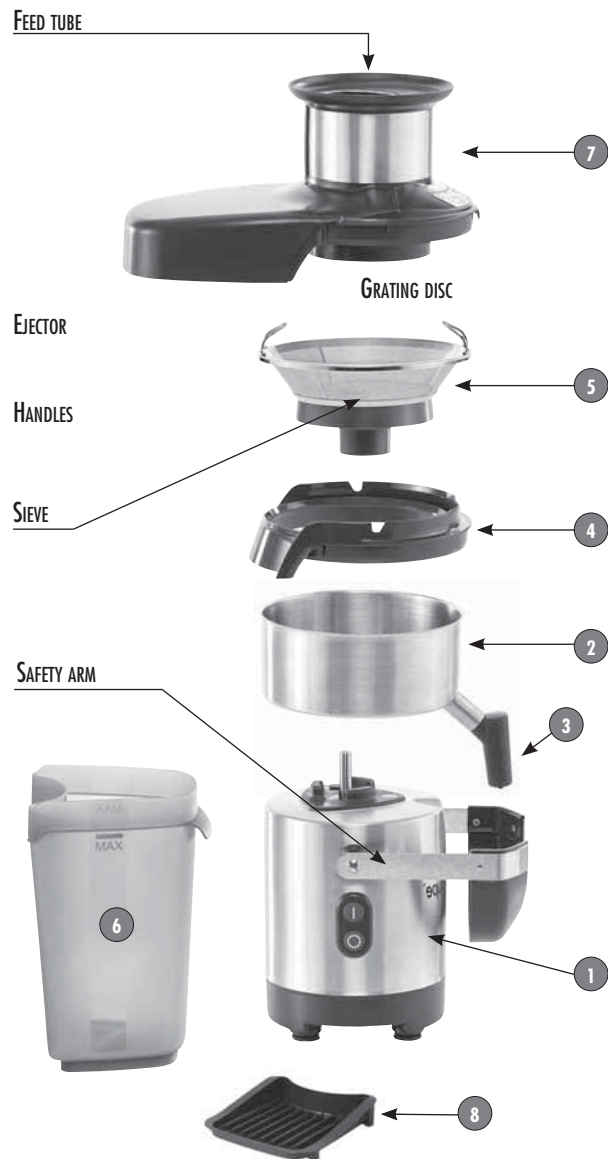

1) Position the motor unit so that the On/Off buttons are facing you.

2) Place the bowl on top of the motor unit.

3) Fit the flange onto the rim of the bowl. The ribs of the flange should be lined up with the flat panel of the bowl. Check that the flange is correctly fitted.

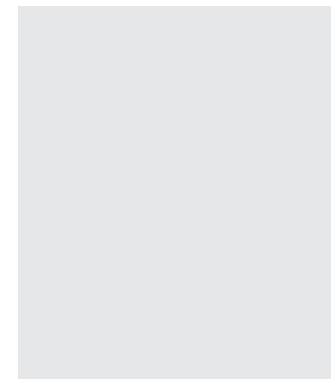

4) Lower the basket into place, holding it by its handles. Rotate it until it slots into place.

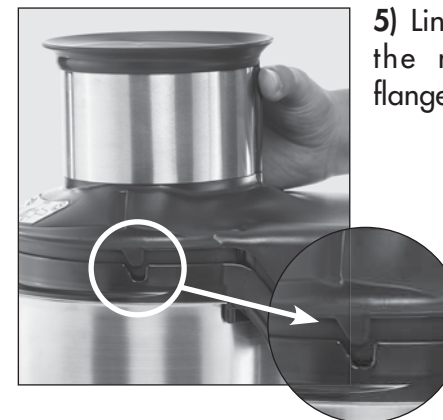

5) Line the lid up with the notches in the flange

IMPORTANT

Make sure that the pin on the motor shaft is correctly lined up with the corresponding notch in the basket hub.

You can also refer to the label (below) stuck to the lid.





6) Position the **pulp container**.

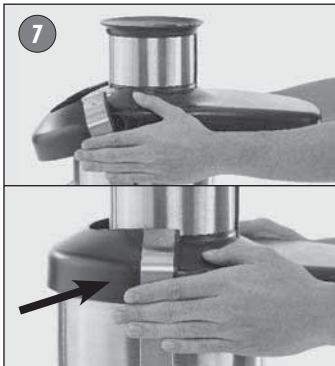

7) Close the safety arm.

To start the machine, press the On button 1. The juicer will not start unless the safety arm has been closed properly (safety switch).

Place a jug underneath the spout. Your juicer is now ready to use!

ASSEMBLY J80 Buffet

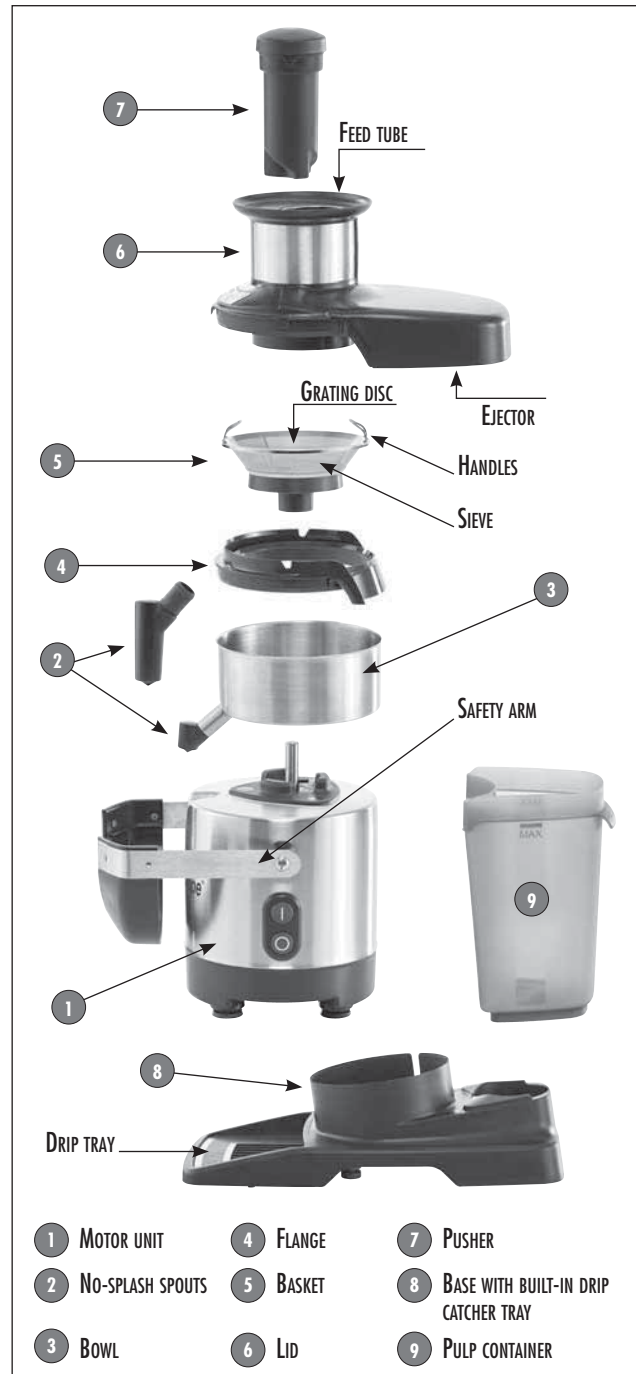

1) Place the motor unit on its base so that the On/Off buttons are facing you. Pass the power cord through the slot provided.

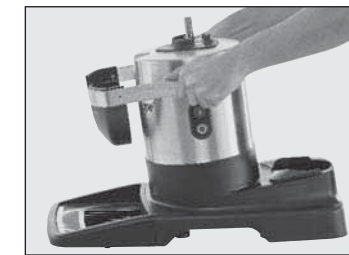
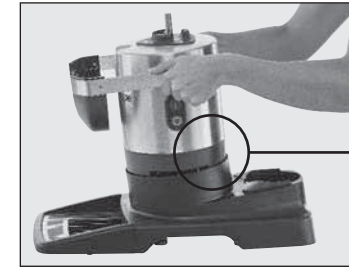

2) Place the bowl on top of the motor unit.



3) Fit the flange onto the rim of the bowl. The ribs of the flange should be lined up with the flat panel of the bowl. Check that the flange is correctly fitted.





4) Lower the basket into place, holding it by its handles. Rotate it until it slots into place.

5) Line the lid up with the notches in the flange

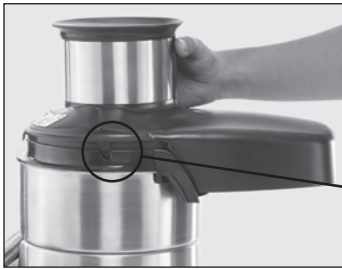

6) Position the **pulp container**.



7) Close the safety arm.

To start the machine, press the On button 1.

The juicer will not start unless the safety arm has been closed properly (safety switch).

Place a jug underneath the spout.

Your juicer is now ready to use!



IMPORTANT

Make sure that the pin on the motor shaft is correctly lined up with the corresponding notch in the basket hub.

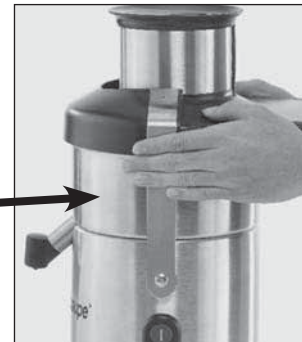

You can also refer to the label (below) stuck to the lid.

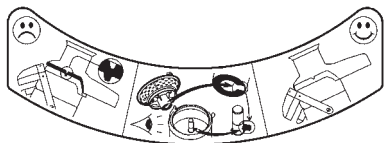

4) Lower the basket into place, holding it by its handles.

Rotate it until it slots into place.

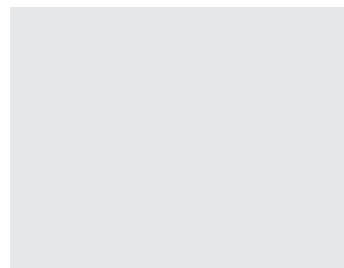

6) Two possible uses:

A) Continuous pulp ejection.



Position the continuous **pulp ejection chute** in the hole in the booster base.

Remember to place a bin (not supplied) directly beneath this chute.

For optimum use of the waste discharge hopper flow-through, you can make a hole in your worktop.

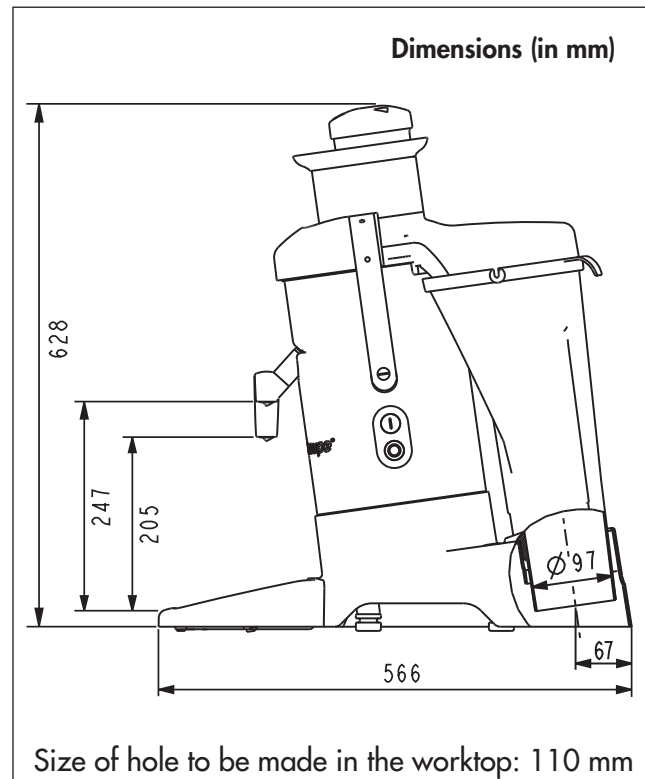

B) Ejection of pulp into the closed pulp container.



Position the **pulp container**

7) Close the safety arm.

To start the machine, press the On button 1. The juicer will not start unless the safety arm has been closed properly (safety switch).

Place a jug underneath the spout.

Your juicer is now ready to use!



8) Using the strap (see page 10) - (Option)

If you have positioned your juicer on the edge of a countertop, attach the ejection chute to **the lid** using **the strap** supplied with the appliance.

RECOMMENDATIONS FOR USE

• J 80 - J 80 Buffet - J 100

- Before you use your juicer for the first time, it is a good idea to wash all the parts that will come into contact with food.
- Always check that the **safety arm** has been closed before using your appliance.
- Always place a container under the spout and either the **pulp container** or the **ejection chute** under the ejector after switching your machine on but before you start feeding the fruit or vegetables in.
- Remember to peel citrus fruit before juicing.

 - **Thick-skinned fruit and vegetables (e.g. pineapples, mangoes) need to be peeled beforehand and any large pips (e.g. melon) removed. Always remove the stones of stone fruit (e.g. peaches, apricots, cherries). Remove all the stems from the grapes before putting them into the juicer.**

- Some foods are not suitable for processing in a juicer, due to their hard consistency (e.g. coconuts).
- **The J 80 - J 80 Buffet - J 100 juicer** features a unique patented Auto Feed system which does away with the need of a pusher.
- To make the best use of your **J 80 - J 80 Buffet - J 100 juicer** therefore, introduce the ingredients into the feed tube by hand (without **the pusher**), according to throughput.
- Introduce the pieces of fruit or vegetables slowly and in small quantities.
- When all the ingredients have gone through, leave the machine on for a few more seconds to extract every last drop of juice.
- Never put ice cubes or frozen fruit in the feed tube.

- The pulp may become unevenly distributed inside the basket, creating an imbalance. If the juicer starts vibrating during operation, turn it off and clean the **basket**. You can then resume juicing.
- Check that the **flange** and **lid** are correctly positioned.

• J 80 - J 80 Buffet

- With **J 80 - J 80 Buffet**, you can make several quarts of juice without having to empty **the pulp container**.
Nonetheless, remember to check the level of the pulp in the **container** on a regular basis.
- Check that the **flange** and **lid** are correctly fitted.
- Always make sure that the **pulp container** has been properly positioned.

• J 100

- J 100 with pulp container:

You can make several quarts of juice without having to empty the **pulp container**.
Nonetheless, you should check the level of pulp in the **container** on a regular basis.

- J 100 with ejection chute:

The **ejection chute** (supplied with your appliance) has been designed specifically to cope with high-volume juicing. With the chute, there is no need to keep on emptying the **pulp container** while juicing.

 - **If you are using your juicer on the edge of a worktop, make sure that all its feet are firmly on the work surface. You must also organize your work station so that there is no risk of the juicer tipping over or falling off.**

NB: If you intend to carry out high-volume juicing every day, it is best to use the **continuous pulp ejection chute**, with or without the **booster base**.

Fruit and vegetable preparation

	Preparation
CARROTS	Peeled and left whole, topped and tailed. Feed in 2 or 3 at a time.
APPLES	Washed and left whole (remove stalk and any labels).
STRAWBERRIES	Remove stalks for the taste.
CITRUS FRUIT	Peel all citrus fruit. Oranges and lemons can be left whole.
PINEAPPLES	Peel and cut into eight chunks (3 cuts)
MELONS	Peel and cut into eight chunks.
TOMATOES	Washed and left whole (remove hard green core). Feed in 2 or 3 at a time.
PEPPERS	Washed and cut into quarters lengthwise, according to shape.
CELERIAC	Cut into 6-7 cm chunks
CUCUMBERS	Peeled. Cut into sections measuring approx. 15 cm long.
FENNEL	Cut into 6-7 cm chunks
GINGER	Cut into pieces to make it easier to feed into the juicer. Do not put too many in at a time, to prevent a blockage.
GRAPES	Remove stalks to avoid bitterness.



WARNING

Always wash fruit and vegetables thoroughly to remove all traces of dirt and pesticides.

CLEANING

- Always unplug the machine before cleaning of any kind
- To rinse the machine out between two different batches of fruit, switch the machine on and pour a glass of drinking water into the feed tube.



- Clean the basket by scrubbing the outside of the filter cone with a brush or scouring sponge before putting it in the dishwasher.

- For more thorough cleaning, remove the bowl flange beforehand.
- Remove the spout to clean it.
- Always clean the entire machine after use, washing the flange, bowl, lid and pusher in hot water. Scrub with a brush using an appropriate detergent.
- To avoid damaging the parts, do not tap them against any hard surfaces.

***Tip:** If the pulp has dried hard onto the basket, immerse the basket into hot water for 5-10 minutes to soften it.



IMPORTANT

Check that your detergent is suitable for use with parts made from plastic or stainless steel. Certain highly alkaline products (e.g. with a high concentration of ammonia or caustic soda) are totally incompatible with some plastics and cause them to deteriorate very quickly.



IMPORTANT

Never immerse the motor unit in water or any other liquid and do not spray!

Do not clean it with a foam lance or pressure washer.

If necessary, wipe the motor unit with a damp cloth.

Always unplug your machine first.

TECHNICAL SPECIFICATIONS

- **Motor unit** → stainless steel
- **Bowl** → stainless steel
- **Juicer basket** → stainless steel
- **Grating disc** → stainless steel
- **Ventilated electric motor** → constant speed (3000 rpm)
- **Throughput** → **100-120 kg/hour** of fruit or vegetables* for the **J 80 - J 80 Buffet**.
120-160 kg/hour for the **J 100**.

* In optimum working conditions, i.e. a suitable worktop, ready prepared fruit and accessories (jug, bin, etc.) all within easy reach.

• WEIGHT

	Net	Gross
J 80	12 kg	13 kg
J 80 Buffet	13 kg	16 kg
J 100	15 kg	18 kg

• DIMENSIONS (in mm)

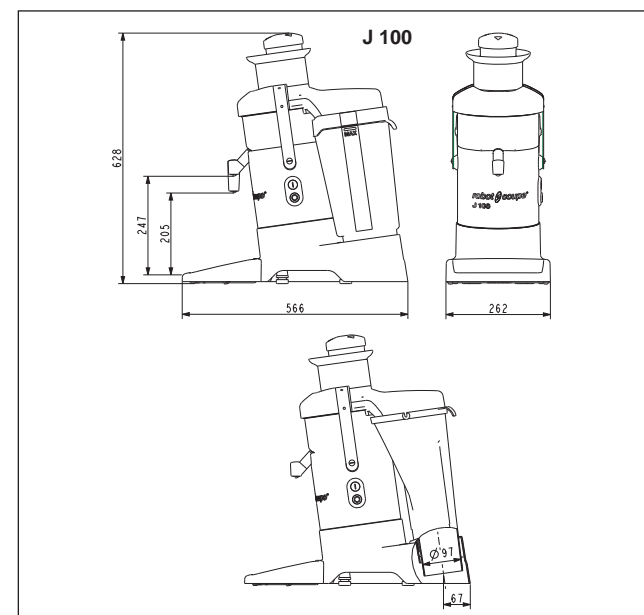
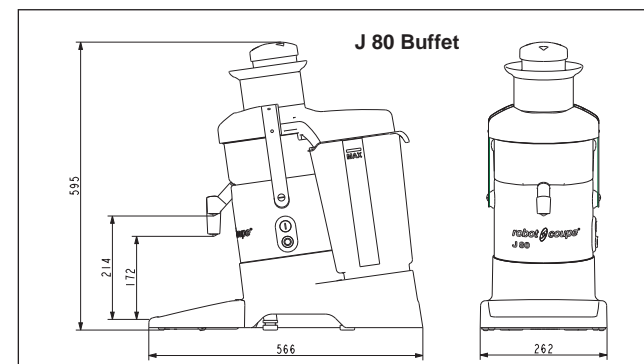
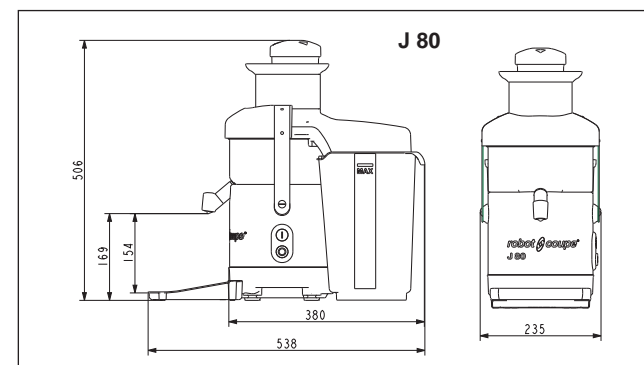

• WORKING HEIGHT

We recommend placing the juicer on a flat, stable work top at a suitable height.

• NOISE LEVEL

The equivalent continuous sound level when the juicer is running empty is below 70 dB (A).

• ELECTRICAL DATA

J 80 - J 80 Buffet

Motor	Speed (rpm)	Intensity (Amp.)
120 V/ 60 Hz	3600	9
220 V/ 60 Hz	3600	6
230 V/ 50 Hz	3000	7

J 100

Motor	Speed (rpm)	Intensity (Amp.)
120 V/ 60 Hz	3600	9
220 V/ 60 Hz	3600	8
230 V/ 50 Hz	3000	8

The power is specified on our data plate.

SAFETY

- The juicer will not start unless the **lid** has been correctly positioned and the **safety arm** properly locked in place. The motor will switch itself off as soon as you open the safety arm or press the Off button (red button).
- The juicer is equipped with a powerful electric brake which will shut the machine down in less than 2 seconds if you open the safety arm while the juicer is running.
- To switch your juicer back on, simply fold the safety arm back over **the lid** and press the On button (green button).

- **The J 100** is fitted with a thermal protection system which automatically switches the motor off if it remains overloaded for any length of time. If this happens, wait for the appliance to cool down before resetting **the thermal protection** (button on underside of the appliance).
- **WARNING:** never use the appliance without either the pulp container or the continuous ejection chute (for the **J 100**).
- Always switch the machine off before removing the pulp container or the continuous pulp ejection chute (for the **J 100**).
- Never insert your hand or any object other than the pusher into the ejector if the machine is plugged in or the basket is rotating.
- Never unplug the appliance by tugging on the power cord or with damp hands.



REMEMBER

- **Never try to override the locking or safety systems.**
- **Never introduce anything other than fruit or vegetables into the feed tube.**
- **The lid of your appliance features a unique patented Auto Feed system. Simply introduce the food into the feed tube and let the machine do the rest.**
- **Should a blockage occur inside the feed tube, NEVER USE any object other than the pusher to clear it. Another solution is to switch the machine off and remove the food causing the problem inside the tube.**
- **Never use your hand to push the food down into the feed tube.**
- **Never insert your hand or any object other than the pusher into the ejector if the machine is running or the basket rotating.**



TROUBLESHOOTING

SYMPTOMS	CAUSES AND/OR REMEDIES
The machine will not start.	<ul style="list-style-type: none"> - Check the fuses in your mains supply. - Close the safety arm properly. <p>J 100:</p> <ul style="list-style-type: none"> - Check that the thermal protection (button on underside) has been reset.
Abnormal noise.	<ul style="list-style-type: none"> - The appliance has been incorrectly assembled. See "Assembly" chapter. - One of the parts is faulty and needs replacing.
Inefficient grating.	<ul style="list-style-type: none"> - The grating disc is worn. Replace the grating disc inside the basket. - There is a blockage in the feed tube which needs to be cleared.
The appliance vibrates.	<ul style="list-style-type: none"> - The pulp container is full or the basket is out of balance due to an accumulation of pulp on the filter. - If the vibration is permanent, check that the basket has not been damaged in some way.
The basket does not stop immediately when the safety arm is opened. It takes more than 2 seconds to stop.	<ul style="list-style-type: none"> - Have the appliance checked by a qualified person.

IMPORTANT: For all repairs and maintenance, it is vital to use parts supplied by Robot-Coupe.

STANDARDS

Consult the declaration of compliance on page 2.

robot  *coupe*®

TECHNICAL DATA



	Français	English	Espanol	Deutsch
CD	Condensateur de démarrage	Starting capacitor	Condensador d'arranque	Anlasskondensator
DT	Coupe-circuit *	Circuit breaker *	Disyuntor *	Ausschalter *
EA	Phase auxiliaire	Starting phase	Fase auxiliar	Hilfsphase
EP	Phase principale	Main phase	Fase principale	Hauptphase
KD	Relais de démarrage	Starting relay	Rele d'arranque	Anlassrelais
MA	Interrupteur MARCHÉ / ARRÊT	ON / OFF switch	Interruptor MARCHA / PARADA	Stop / Betriebsschalter
MF	Module de freinage	Braking module	Módulo de frenado	Bremsmodul
MO	Moteur monophasé	Single phase Motor	Motor monofasico	Motor einphasig
PTO	Protecteur thermique du moteur	Motor thermal protector	Protector termico del motor	Motorthermoschutz
R	Résistance 1 Ohm 6 W	Resistor 1 Ohm 6 W	Resistencia 1 ohmio 6 W	Widerstand 1 Ohm 6 W
SW	Interrupteur sécurité étrier	Clamp safety switch	Interruptor de seguridad cojinet	Steigbügel zur Deckelsicherheit

* N'est pas utilisé sur tous les modèles - Is not used on all models
No utilizado con todos modelos - Ist nicht bei allen Modellen verwendet

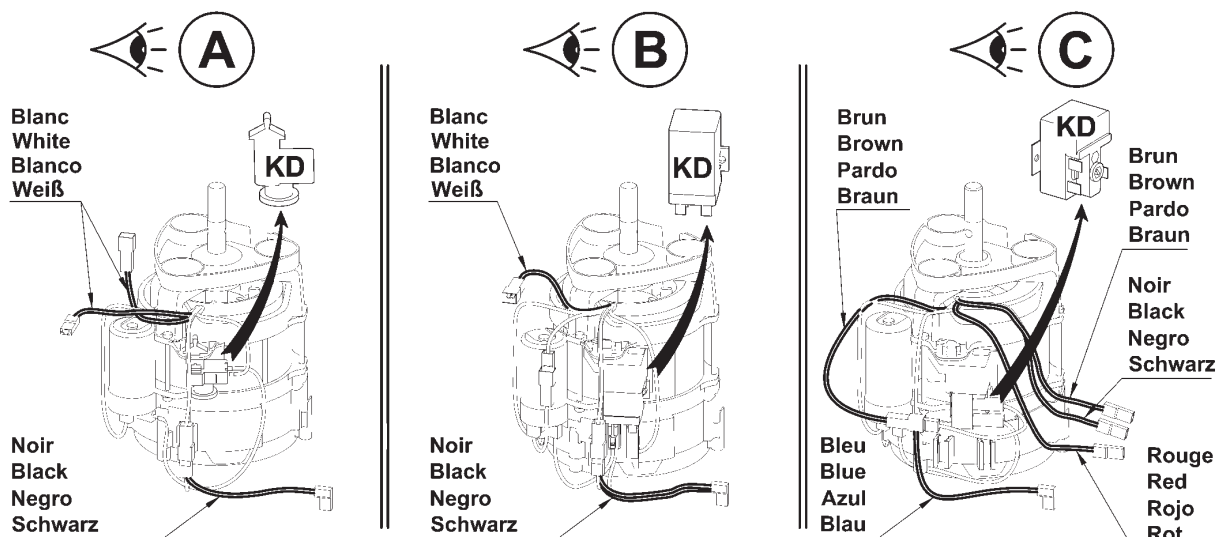

rouge / red / rojo / rot → 120V/60Hz
violet / purple / púrpura / violett → 220V/60Hz
blanc / white / blanco / weiß → 220-240V/50Hz

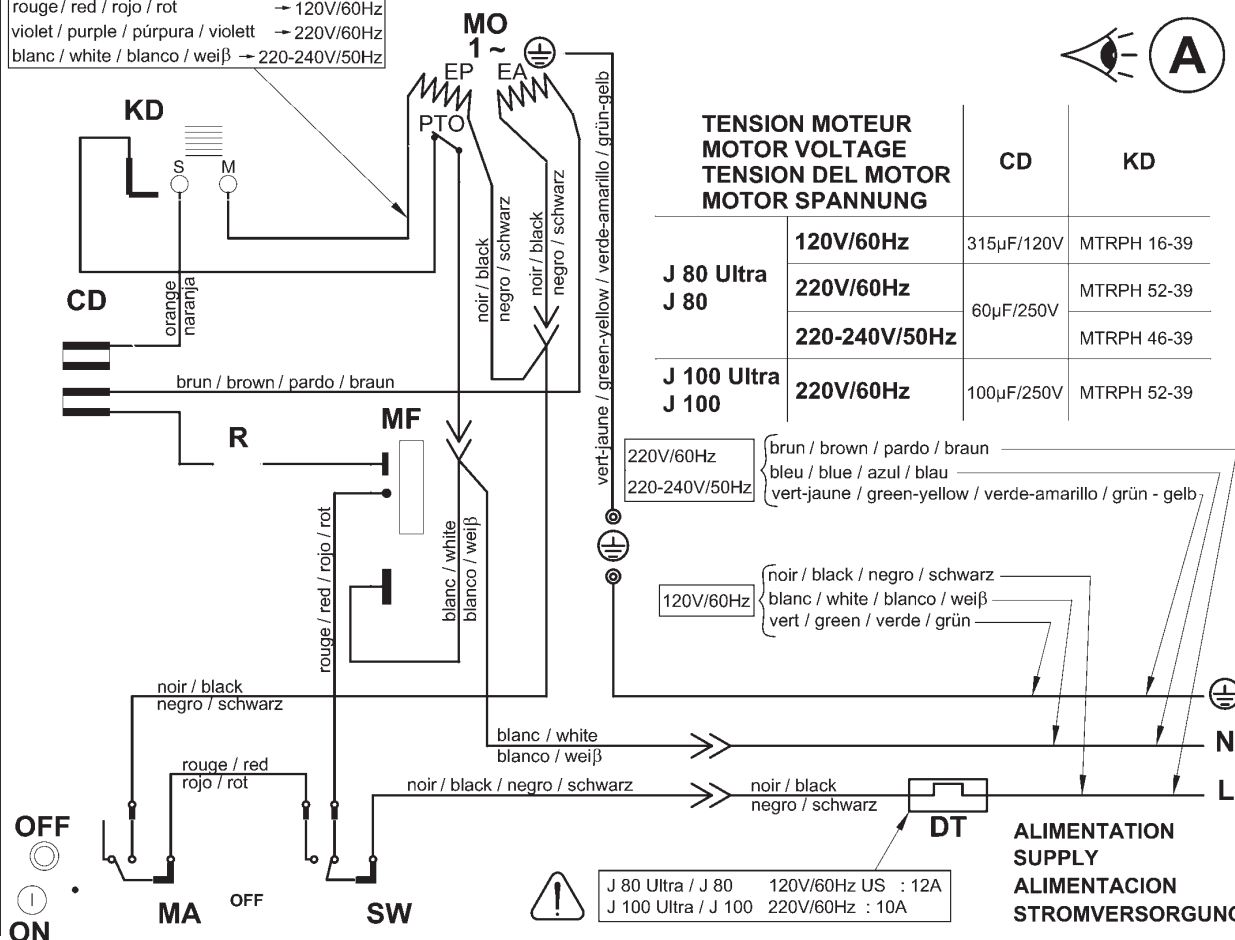

J 80 Ultra / J 80 120V/60Hz US : 12A
J 100 Ultra / J 100 220V/60Hz : 10A

J 80 Ultra / J 80 - J 100 Ultra / J 100

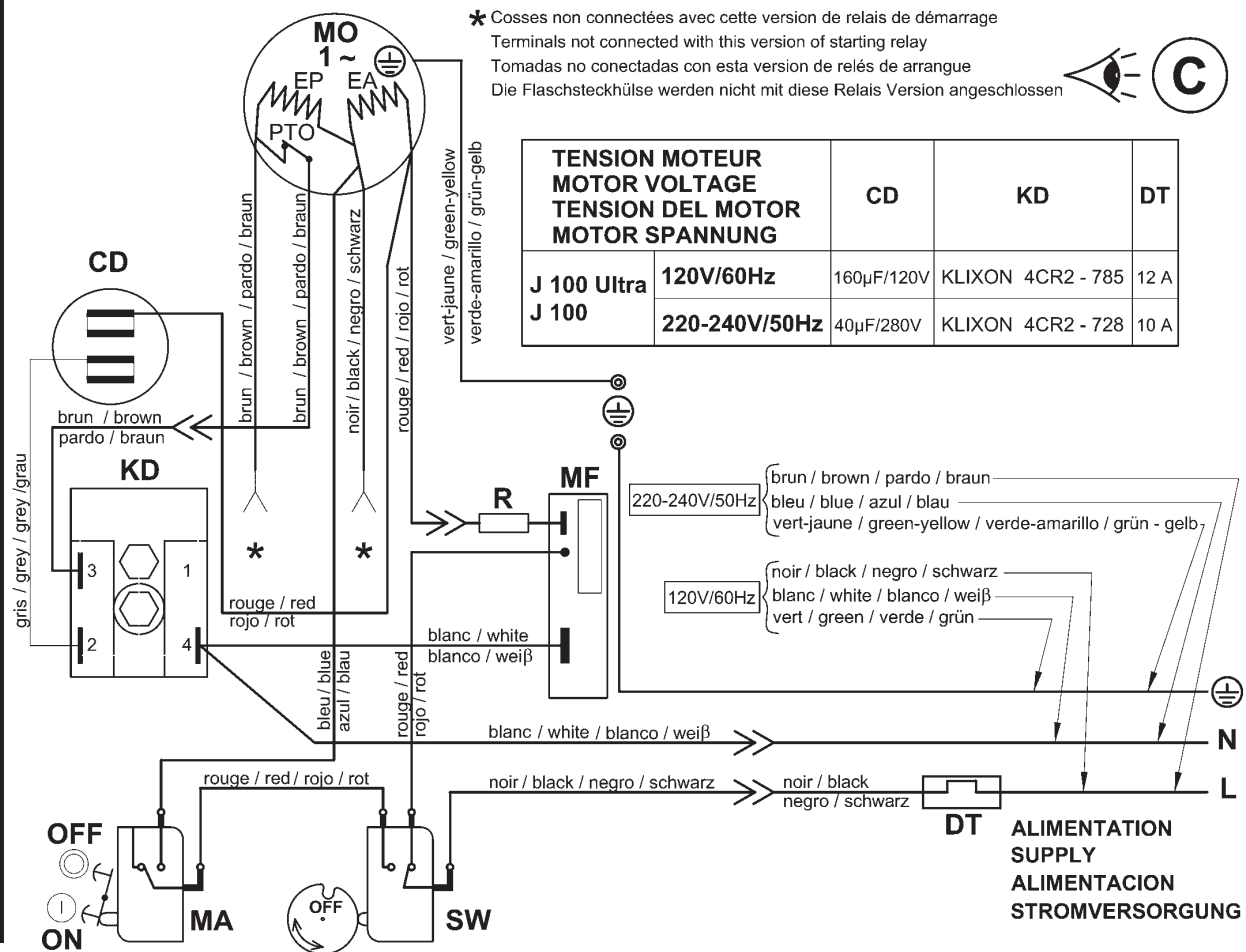
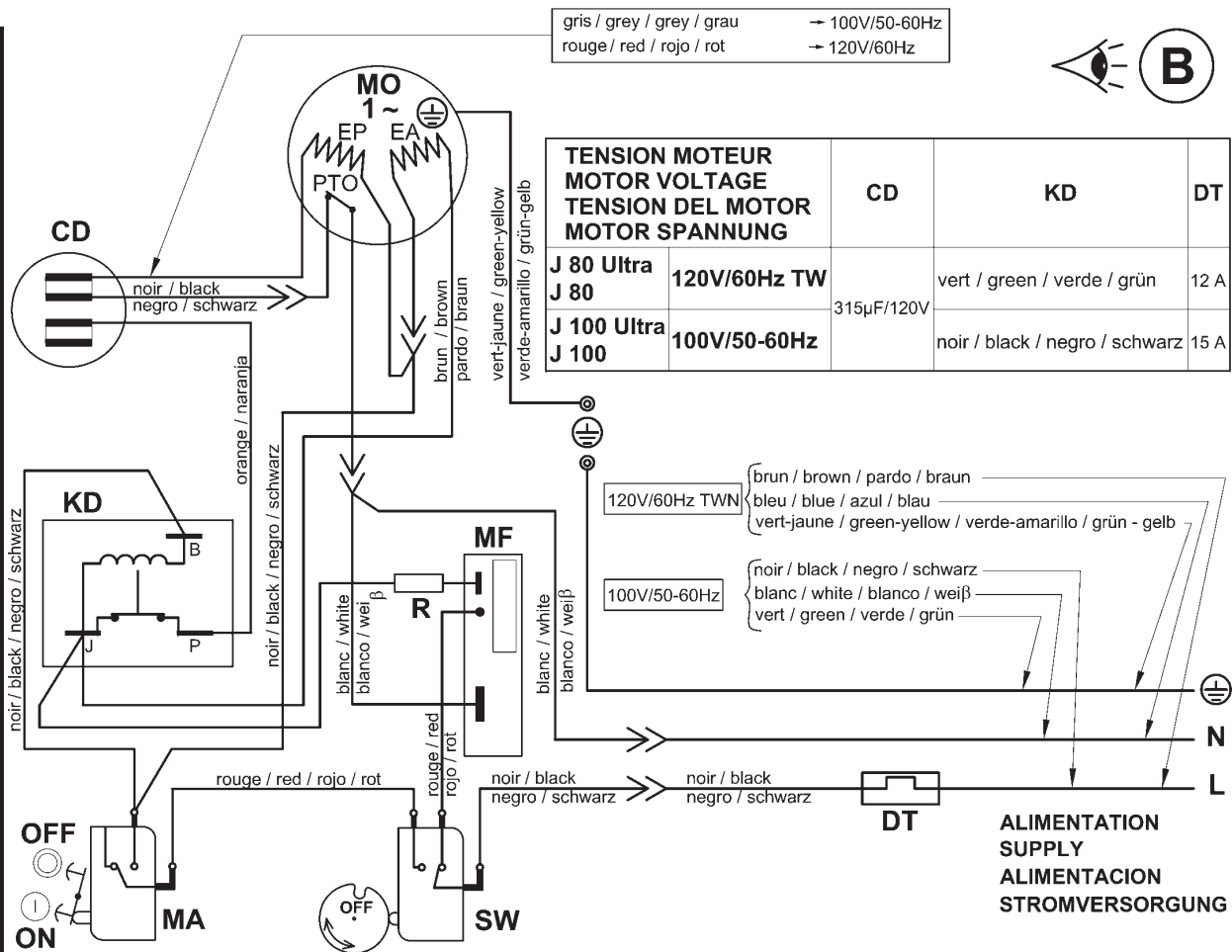

N° 400228 2/2 (f)

robot coupe®

Maj : 11/19

1

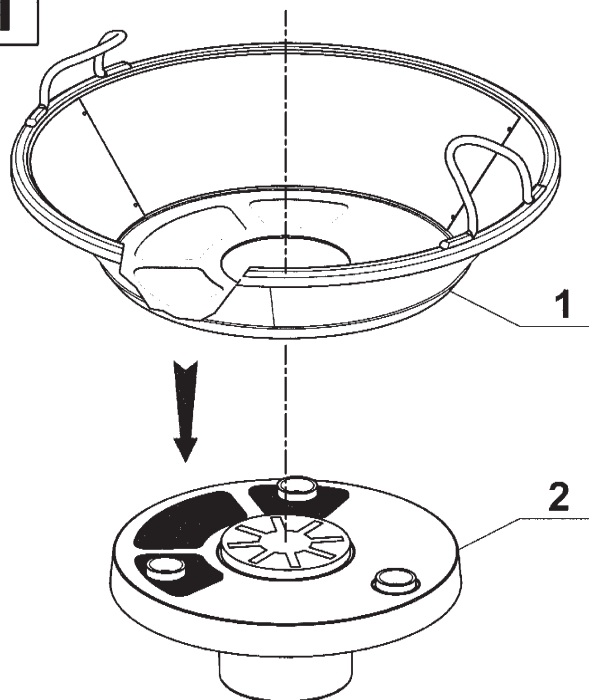

2

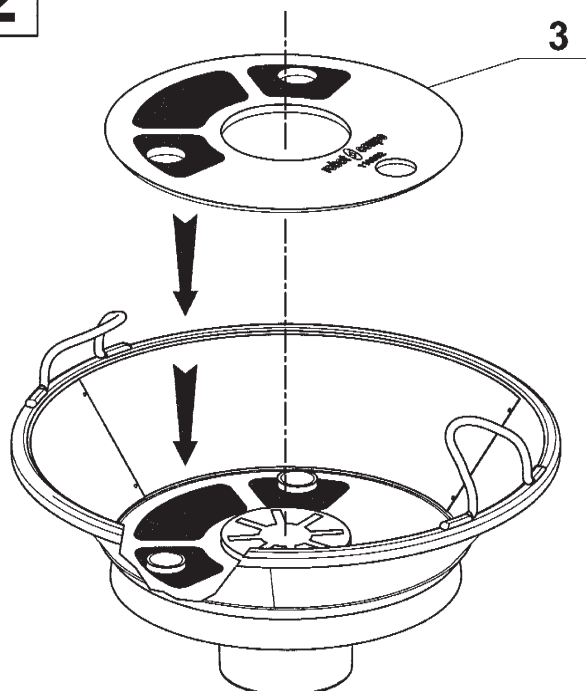

3



**A aligner
To align**

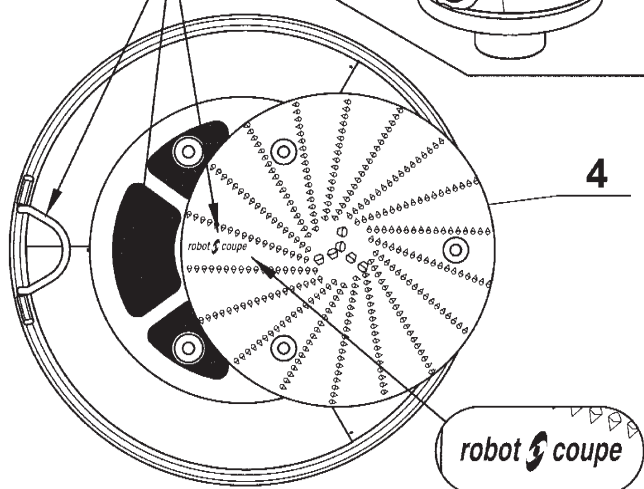
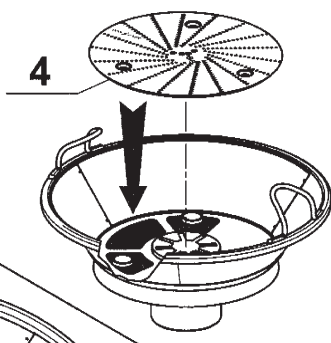

4



**VERIFIER LA FORME DU MOYEU
CHECK THE HUB SHAPE**

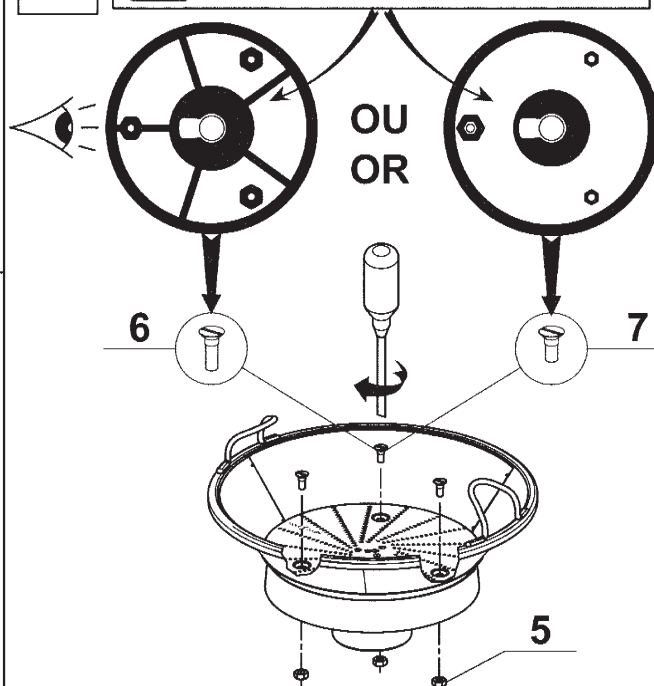

Index	Pièce / Part	Désignation	Description	Quantité / Quantity
1	39 912	FILTRE	SIEVE	1
2	39 913	MOYEU	HUB	1
3	39 929	RONDELLE INCLINEE	ANGLED SPACER	1
4	39 911	DISQUE RAPEUR	GRATER	1
5	206 162	ECROU HM4 INOX	NUT HM4 (Stainless Steel)	3
6	200 123	VIS F M4x12 INOX	SCREW M4x12 (Stainless Steel)	3
7	206 972	VIS F M4x10 INOX	SCREW M4x10 (Stainless Steel)	3



robot coupe®

**Head Office, French,
Export and Marketing Department:**
48, rue des Vignerons
94305 Vincennes Cedex- France
Tel.: 01 43 98 88 15
Email: international@robot-coupe.com

**Robot Coupe
Australia Pty Ltd:**
Unit 3/43 Herbert St
Artarmon NSW 2064 Australia
Tel.: (02) 9478 0300
Email: orders@robotcoupe.com.au

**Robot-Coupe
U.K. LTD:**
Fleming Way, Isleworth,
Middlesex TW7 6EU
Tel.: 020 8232 1800
Email: sales@robotcoupe.co.uk



37002314404174

Ref : 404 174 - 16/01/2020